

This drawing is property of I. Arruti and must not be copied, exhibited or furnished without the written consent of I. Arruti.

No.	DATE	MODIFICATION	REASON
2	15/01/20	DC-50,4X31-R/T is added.	---
1	09/09/19	The dimension has changed.	---
0	19/03/18	Edited in new format.	CAD software change.

JUMPER TERMINAL REFERENCE	CODE	ØA (mm)	B (mm)	WEIGHT (Kg)
DC-50,4x15,5-R/T	----	15,5	14,5	1,44
DC-50,4x21-R/T	----	21	14,5	1,39
DC-50,4x26-R/T	----	26	17	1,40
DC-50,4x27-R/T	----	27	15,5	1,38
DC-50,4x29-R/T	----	29	15,5	1,35
DC-50,4x29,5-R/T	----	29,5	15,5	1,34
DC-50,4x30-R/T	----	30	15,5	1,34
DC-50,4x31-R/T	14165	31	14,5	1,26
DC-50,4x32-R/T	----	32	14,5	1,24
DC-50,4x33-R/T	12920	33	13,5	1,21
DC-50,4x33,5-R/T	----	33,5	13,5	1,20

MARKS:
 LOT
 REFERENCE
 43,5
 50 Nm

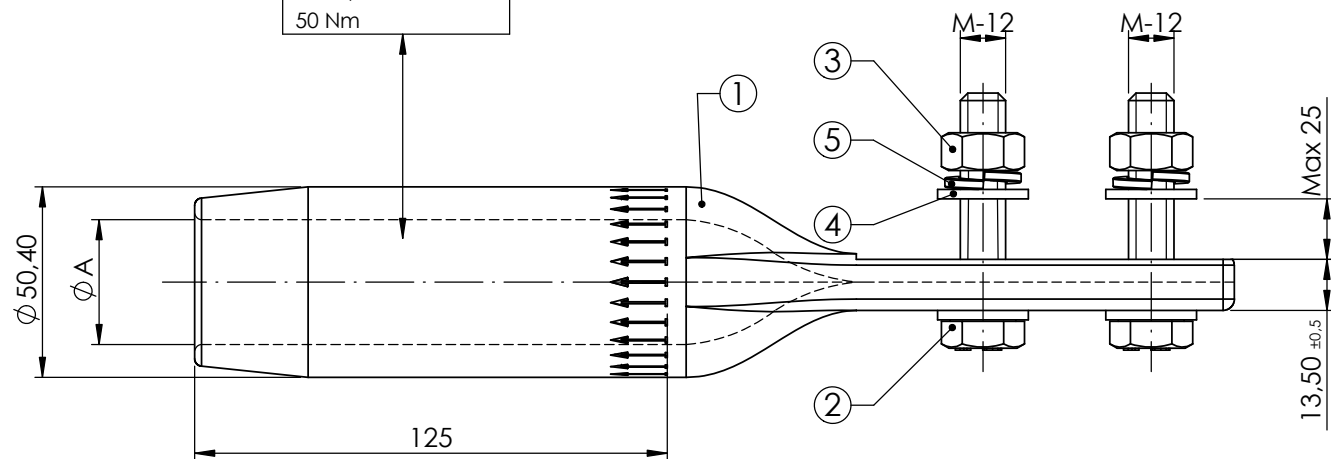
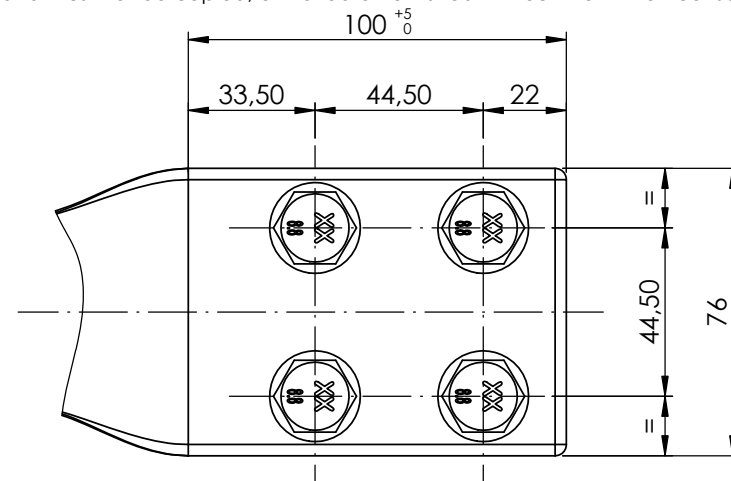

DISTANCE BETWEEN FACES AFTER COMPRESSION:

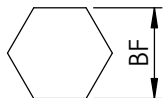

ALUMINIUM: 43,5mm.



NAME
 DRAWN BY E.V.
 SIGNED BY I.L.

No.	QTY.	DESCRIPTION	MATERIAL	CODE	STANDARD	WEIGHT (Kg.)
5	4	SPRING WASHER M-12	GALVANISED STEEL	0164	DIN-127	0.00
4	8	FLAT WASHER M-12	GALVANISED STEEL	0047	DIN-125	0.01
3	4	NUT METRIC 12	GALVANISED STEEL	0013	DIN 934	0.02
2	4	BOLT M12x60 SHANK 26 8.8	GALVANISED STEEL	0621	DIN-931	0.07
1	1	JUMPER TERMINAL	ALUMINIUM	-	EN-AW-1050H	TABLE

UNITS (mm.)

 - Manufactured according to IEC 61284 standard
 - Tolerances unless otherwise stated to be:
 Up to and including 35 mm. ±0.7 mm. Over 35 mm. ±2%
 - Torque: 50 Nm
 - Hot dip galvanized according to ISO 1461 standard
 - Coating thickness. Local: 40µm. Average: 50µm

TOTAL WEIGHT: Kg.

STRAIGHT JUMPER JOINT
DC-50,4xA-R/T

SCALE 1:2
 DRAWING DC50T/R-M
 ISSUE 0